

PERSHING 62

Day Yacht Charter



EYUCOMPANY

HIGH-PERFORMANCE YACHT

Top speed is 45 knots

Experience speed is over 100KM

The pull of the wave, known as the "nose tail," is a spectacle to behold.

The openness of the main salon and the aft deck allows guests to enjoy a good time as one.

SPECIFICATION

LENGTH	62 ft / 18.94 m
BEAM	15.9 ft / 4.80 m
DRFAT	4.9 ft / 1.45 m
CRUSING SPEED	40 Knot
TOP SPEED	25 Knot
BUILT	2017
BUILDER	PERSHING
ENGINE	MTU1548hp x 2
LOCATION	TOKYO, YOKOHAMA, OTHER
CHARTER RATE	JPY 800,000 + SALES TAX

KEY FEATURES

- Elegant Modern Design by Poltrona Frau
- Main salon Integration for Up/Down Aft deck window
- Spacious Swimming platform
- Karaoke & Movie
- FB BBQ Grill
- Jet Tender



GUESTS
6-12



CABIN
3



CREW
3



Jet Tender
3 Person



Banana Boat
4 Person



The Tokyo Bay Sample Itinerary

1: On Board Tokyo Bay port → Yokohama

2: Yokohama → South of Tokyo or Chiba Cove

3: Chiba Cove → Yokohama → Tokyo







LAYOUT

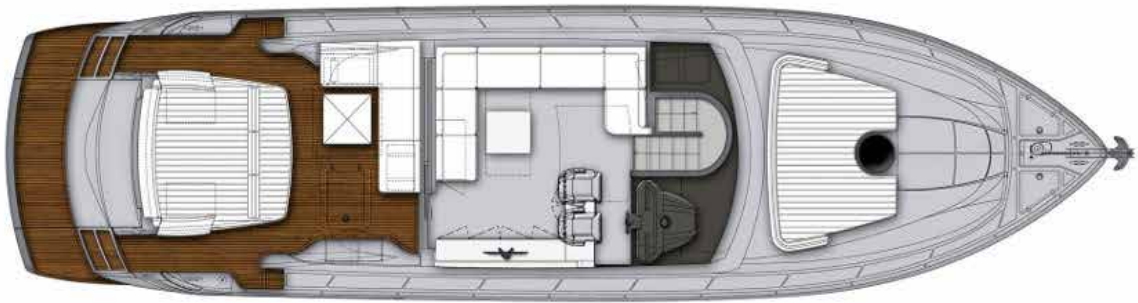

Allowing the experts at Lyucompany to perfect every detail of your charter takes all the worry away. Start with this website. It is a general introduction to just some of the many superb yachts available for charter. More detailed information on these and other yachts in our charter portfolio are available on request. If you are uncertain about your charter requirements, our brokers will be delighted to advise you. Similarly, if you wish to check the availability of any given vessel, please contact us. Our specialist brokers are readily on hand to provide every guidance as well as a wealth of discerning expertise.



THE CHARTER AGREEMENT

After the availability of your chosen yacht has been verified, you will receive a standard MYBA Charter Agreement for signature. If your chosen cruising itinerary necessitates embarking or disembarking from a point other than your yacht's home port, positioning charges (delivery/ redelivery fees) may be required. These charges, if applicable, will be confirmed in advance and affirmed in the Charter Agreement, together with any taxes that may apply.



PAYMENT TERMS

A deposit of 50 per cent of the total charter fee is payable by bank transfer immediately on signature of the MYBA Charter Agreement. The remaining 50 per cent, plus an Advance Provisioning Allowance, together with any taxes, delivery/redelivery fees and any additionally agreed charges, is payable by bank transfer five weeks before the commencement of the charter.



OPERATING EXPENSE

The Advance Provisioning Allowance (APA) is due at the time of the final charter payment. Under MYBA terms, this sum is usually equivalent to 30 per cent of the total charter fee, but may be up to 40 per cent in some cases. Intended to cover the operating expenses of a charter as explained under Charter Terms, such as fuel, food, drinks, port fees and ad hoc incidentals, the APA will be given to the captain before the start of your charter. The Captain will ensure that the yacht is fully fuelled and provisioned when you step on board. While an up-to-date summary of accounts can be requested at any time during your charter, a full set of accounts will normally be submitted by your captain at the end of the cruise. If, during the charter, the expenditure exceeds the sum already paid, additional cash funds will be required at once. All outstanding bills from the yacht charter should be settled in cash or by bank transfer before your final disembarkation. Of course, any remaining credit at the end of your charter will be reimbursed to you in full. On request, transfer arrangements to and from the yacht can be made by Burgess or by the yacht's captain, payment for which will be deducted from your APA.



EVERY DETAIL COUNTS

Several weeks before you board your yacht, Burgess will ask you to complete a detailed questionnaire describing the preferences and special needs of all the members of your party, such as dietary or medical requirements, details of any allergies, and your sporting or entertainment requests. This will enable Burgess and the crew of your chosen charter yacht to ensure that everything possible is done to make your charter a fabulous experience.



SATELLITE TELEVISION SYSTEMS

Where these are provided please note that service cannot always be guaranteed due to differing signal strengths across the world and satellite receivers vary in capability from one yacht to another. If satellite television is important during your charter, please check with your broker to avoid any disappointment.



INTERNET

There is standard wireless access provided through out most yachts although in certain areas the service can be limited and cannot be guaranteed. If you anticipate regular use of the internet or require large bandwidths during your charter, please let Burgess know before you board as upgrades may be subject to availability and there is likely to be a charge made to your account according to your requirements.



SMOKING ON BOARD

Smoking is only allowed outside on deck and in the case of some yachts in dedicated outside areas only. Please consult Burgess for verification. For safety reasons, smoking in cabins and staterooms is prohibited on all yachts.



RECREATION EQUIPMENT

The recreation equipment listed for the yachts is believed to be correct but cannot be guaranteed as they are liable to change at short notice. Should changes become necessary, the owner of the yacht will make every effort possible to comparably replace the equipment. Personal watercraft (jetskis, waverunners etc) may be restricted in certain cruising areas and guests will also require an appropriate operating licence. Please check with Burgess first for any guidelines or if you have any specific requirements in this regard.



INSURANCE

Burgess strongly recommends charterers take out Cancellation and Curtailment Insurance to protect their investment if unforeseencircumstances prevent or curtail their charter. Additionally, all members of the charter party should be covered by Personal Accident and Medical Insurance, and their personal effects should be insured against theft, loss or damage. Other forms of insurance, such as Charterer's Liability may also be prudent. Our brokers will be pleased to assist you with additional advice in this matter.

FURTHER INFORMATION

VALUE ADDED TAX

Please note that due to Japan Union tax legislation, Sales Tax may be charged on the gross Charter Fee and delivery costs for charters taking place in Japanese Waters. Local taxes may also apply in other countries and our brokers will provide any prevailing rates according to your chosen cruising destination and itinerary.

World-class worldwide

Lyucompany is the market-leading full-service and Charter yacht company.



Contact Broker: Lyu Kamikage

T: +81(0)90 2661 7373

E: charter@lyucompany.com

Lyucompany co .ltd

4-2 Marina Plaza 4F ShirahoKanazawa Yokohama
Kanagawa 236-0007
Japan

Lyucompany.jp



PERSHING62 MOVIE

Riva
EXCLUSIVE DEALER